

i7 Smart

4-Gang Multifunction smart switch modu

le(2 scene+2 switch)

Basic Information

Model no	<i>70E854TY</i>
Range	<i>i7 Smart</i>
Type	<i>Smart Switch</i>
Finishing	<i>white</i>

Product Information

Communication	<i>ZigBee</i>
Highlights	<i>Remote Control</i> <i>Timer Control</i> <i>Schedule Control</i> <i>Voice Control</i> <i>2 scene switch + 2 gang smart switch</i>
Norminal Voltage	<i>250V~50Hz</i>



Operational Voltage	176VAC-264VAC
Load	□4W,200W/Gang

Installation and maintenance

IP protection	IP20
Material	PC (polycarbonate)
Operating temperaturerange	-10°C~40°C
Installationtype	wall mounted

Additional information

Quantity per box	8
Boxsize(mm)	375*95*105
Quantity per carton	80
Carton size(mm)	495*385*220



1 Network Environment

1.1 Basic Requirement for Network

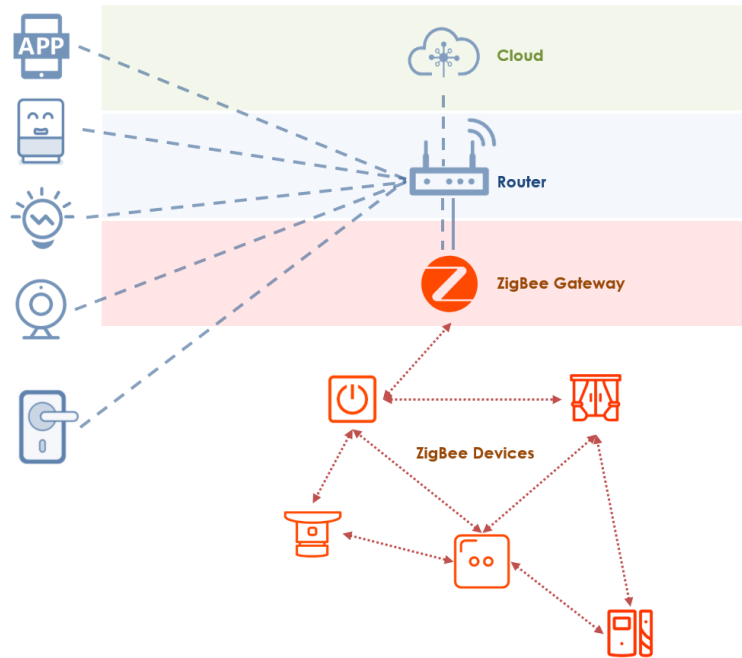

Wi-Fi — Home Router

- Support 2.4GHz Wi-Fi, select 2.4GHz Wi-Fi signal
- 2.4G/5G combination Wi-Fi is not supported
- Can check the Wi-Fi type on the mobile phone or PC

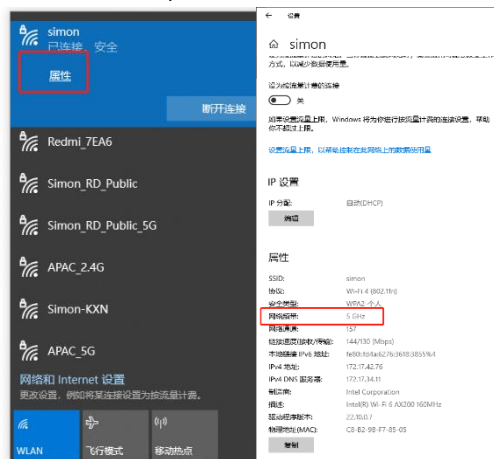

Simon-Smart Installation Manual

ZigBee — Smart Gateway

- Need to be connected with home router via network cable or Wi-Fi
- Connect ZigBee devices to internet

Tips: Change network environment of Smart Gateway (LAN)

- Change the Wi-Fi password/ Wi-Fi Name: Smart Gateway (LAN) and ZigBee devices under the gateway will not be influenced, but Wi-Fi devices will be offline.
- Change the router: Smart Gateway (LAN) and ZigBee devices under the gateway will not be influenced, but Wi-Fi devices will be offline.

Change network environment of Smart Gateway (Wireless)

- Change the Wi-Fi password/ Wi-Fi Name: Smart Gateway (LAN), ZigBee devices under the gateway and Wi-Fi devices will be offline.
- Change the router: Smart Gateway (LAN), ZigBee devices under the gateway and Wi-Fi devices will be offline.

***In the Situation that smart gateway and ZigBee devices under the gateway are offline, long press the button on the gateway to reset it, and make network configuration of gateway again, then they can work normally.**

For offline Wi-Fi devices, need to reset them and make network configuration again.

1.2 Smart Gateway

The smart gateway is the control center of the ZigBee device.

Parameters:

Code	681808TY	S00E0-S008	S00E0-S009	55E761TY/ 70E761TY/ 58E8061TY/ 72E8061TY/ 30E8061TY	S00E0-S026 S00E0-S042
Communication	LAN/ZigBee		Wi-Fi/ZigBee		Wi-Fi/ZigBee
Power Supply	USB 5V/1A			220-240V ~50/60Hz	220-240V ~50/60Hz
Recommended Number of connecting devices	Max 100	Max 100	Max 50	Max 30	Max 100

2.3 Multifunction Smart Switch (Scene+switch)

Code	Description
58E8009TY	4 Gang Multifunction smart switch(2 scene+2 switch)
70E854TY	4 Gang Multifunction Smart Switch Module(2 scene+2 switch)
58E8022TY	6 Gang Multifunction Smart Switch(3 scene+3 switch)
58E8023TY	6 Gang Multifunction Smart Switch(2 scene+4 switch)

Installation Environment:

- Need to connect to L&N line in the mounting box

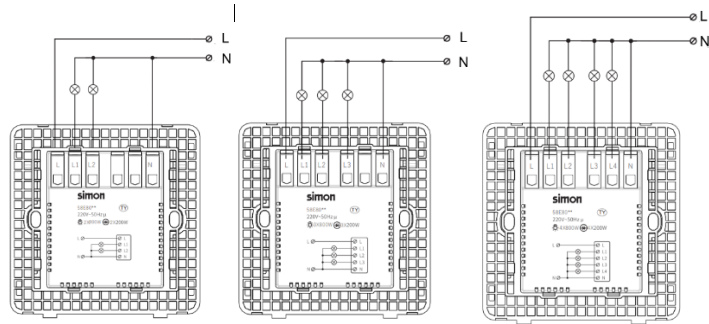

Preparation for Use:

- Ensure that the smart gateway has been added.
- Mobile phone is connected to Internet (Wi-Fi or 3G/4G/5G)
- Ensure effective coverage of ZigBee network. (Communication distance between any ZigBee devices: <2 walls, <100m in open area)

Network Configuration:

- Download and open Simon Smart APP



- After connecting the power, long press the left bottom button of switch until the configuration indicator flashes

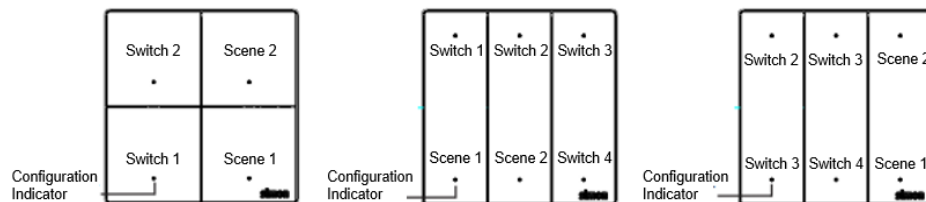

- If not flashes, remove the cover and insert the pin into the reset hole until the configuration indicator flashes

Simon-Smart Installation Manual

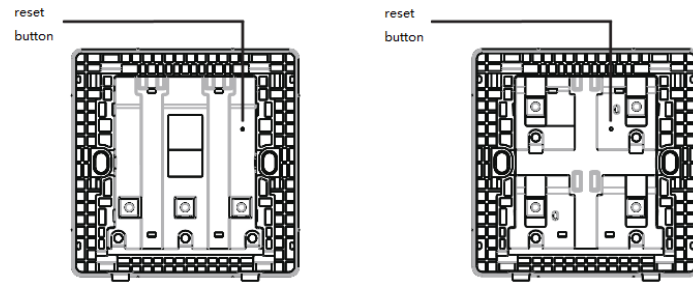

- Open Simon Smart APP, enter the "Gateway" interface and click "Add Subdevice"
- Confirm that indicator is blinking, then click "LED already blink"
- Add the device as per the app prompts

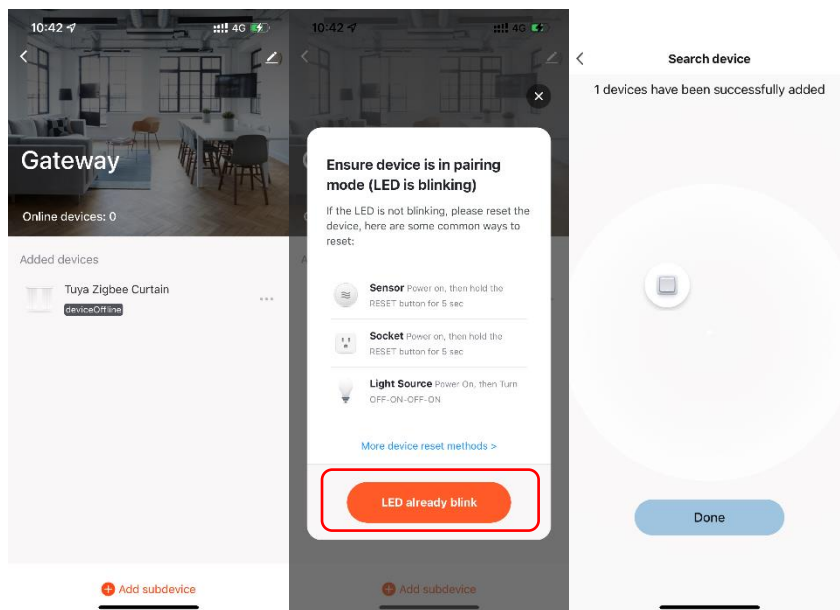

Configuration Indicator Status:

Waiting pairing	4 quick flashes per second
Pairing success	2 flashes per second for 2s
Pairing failure	1 flash per second for 10s
Initial power on	ON for 1s
Reset success	2 flashes per second for 2s