



i7 smart

1-Gang Smart Dimming Switch Module

Basic Information

Model no	70E848TY
Range	i7 smart
Type	Smart Dimming Switch
Finishing	White

Product Information

Communication	ZigBee
Highlights	<p>Adjust the brightness of Triac light freely</p> <p>Wall control, APP control, voice control, timing</p> <p>Scenes and automation with other smart devices</p> <p>LED indicator display setting</p>
Norminal Voltage	250V~50/60Hz
Operational Voltage	176VAC-264VAC
Load	200W/Gang TRIAC



Installation and maintenance

IP protection	<i>IP20</i>
Material	<i>PC (polycarbonate)</i>
Operatingtemperaturerange	<i>-10°C~40°C</i>
Installationtype	<i>wall mounted</i>

Additional information

Quantity per box	<i>8</i>
Boxsize(mm)	<i>375*95*105</i>
Quantity per carton	<i>80</i>
Carton size(mm)	<i>495*385*220</i>



1 Network Environment

1.1 Basic Requirement for Network

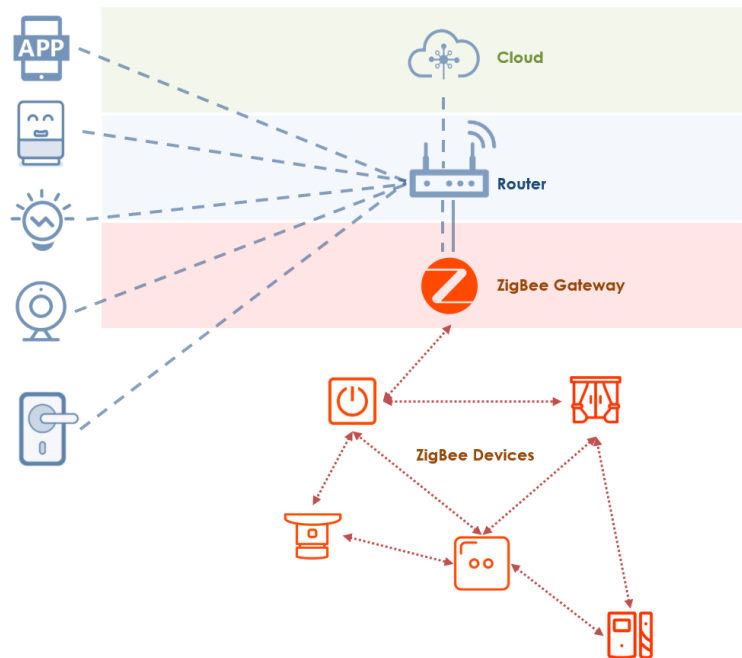

Wi-Fi — Home Router

- Support 2.4GHz Wi-Fi, select 2.4GHz Wi-Fi signal
- 2.4G/5G combination Wi-Fi is not supported
- Can check the Wi-Fi type on the mobile phone or PC

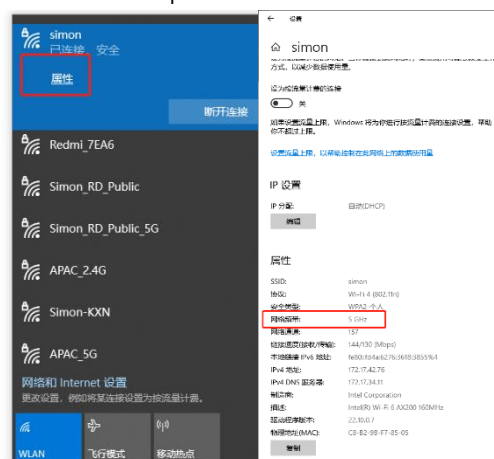

ZigBee — Smart Gateway

- Need to be connected with home router via network cable or Wi-Fi
- Connect ZigBee devices to internet

Tips: Change network environment of Smart Gateway (LAN)

- Change the Wi-Fi password/ Wi-Fi Name: Smart Gateway (LAN) and ZigBee devices under the gateway will not be influenced, but Wi-Fi devices will be offline.
- Change the router: Smart Gateway (LAN) and ZigBee devices under the gateway will not be influenced, but Wi-Fi devices will be offline.

Change network environment of Smart Gateway (Wireless)

- Change the Wi-Fi password/ Wi-Fi Name: Smart Gateway (LAN), ZigBee devices under the gateway and Wi-Fi devices will be offline.
- Change the router: Smart Gateway (LAN), ZigBee devices under the gateway and Wi-Fi devices will be offline.

***In the Situation that smart gateway and ZigBee devices under the gateway are offline, long press the button on the gateway to reset it, and make network configuration of gateway again, then they can work normally.**
For offline Wi-Fi devices, need to reset them and make network configuration again.

1.2 Smart Gateway

The smart gateway is the control center of the ZigBee device.

Parameters:

Code	681808TY	S00E0-S008	S00E0-S009	55E761TY/ 70E761TY/ 58E8061TY/ 72E8061TY/ 30E8061TY	S00E0-S026 S00E0-S042
Communication	LAN/ZigBee		Wi-Fi/ZigBee		Wi-Fi/ZigBee
Power Supply	USB 5V/1A			220-240V ~50/60Hz	220-240V ~50/60Hz
Recommended Number of connecting devices	Max 100	Max 100	Max 50	Max 30	Max 100

5 Smart Dimming Switch

5.1 17 Smart Dimming Switch (Triac light)

Code	Description
70E848TY	1 Gang Smart Dimming Switch Module
70E849TY	2 Gang Smart Dimming Switch Module

Installation Environment:

- Need to connect to L&N line in the mounting box
- Need to connect to load, TRIAC lighting

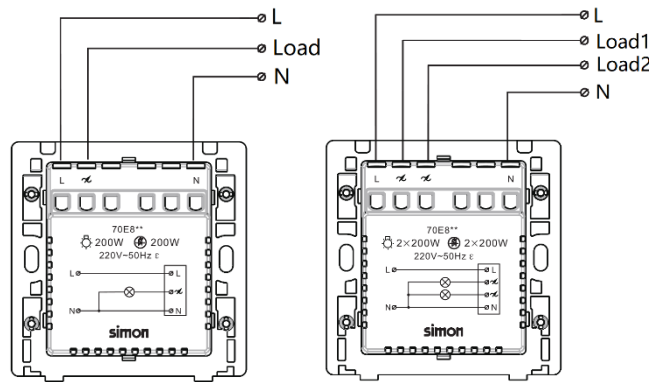

Preparation for Use:

- Ensure that the smart gateway has been added.
- Mobile phone is connected to Internet (Wi-Fi or 3G/4G/5G)
- Ensure effective coverage of ZigBee network. (Communication distance between any ZigBee devices: <2 walls, <100m in open area)

Network Configuration:

- Download and open Simon Smart APP



- Within 60s after connecting the power, long press the configuration button for more than 3s until the configuration indicator flashes
- If not flashes, long press the configuration button for more than 20s until the configuration indicator flashes

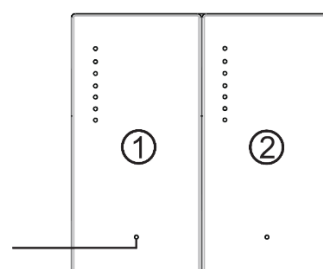
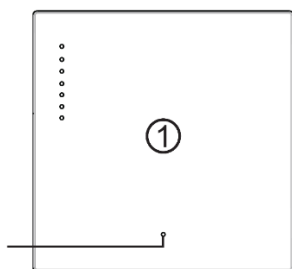

Simon-Smart Installation Manual

- Enter the “Gateway” interface and click “Add Subdevice”
- Confirm that indicator is blinking, then click “LED already blink”
- Add the device as per the app prompts

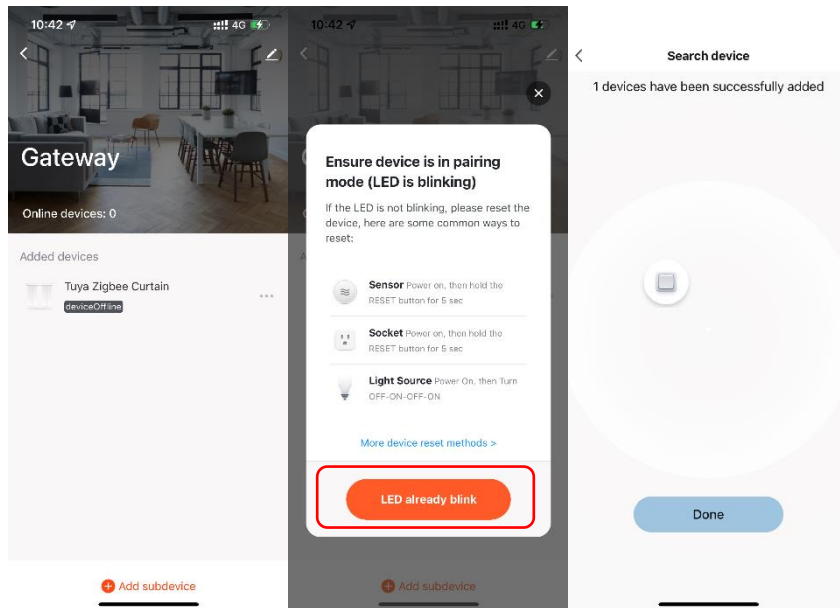

Configuration Indicator Status:

Waiting pairing	4 quick flashes per second
Pairing success	2 flashes per second for 2s
Pairing failure	1 flash per second for 10s
Initial power on	ON for 1s
Reset success	2 flashes per second for 2s