



## i7 smart

1 Gang Smart Curtain Switch Module

### Basic Information

Model no	<i>70E846TY</i>
Range	<i>i7 smart</i>
Type	<i>Smart Curtain Switch</i>
Finishing	<i>White</i>

### Product Information

Communication	<i>ZigBee</i>
Highlights	<i>Control the curtain any time in any room</i> <i>Connect 4/5 wire strong curtain motor</i> <i>Wall control,APP control,voice control,timing</i> <i>Scenes and automation with other smart devices</i>
Norminal Voltage	<i>250V~50/60Hz</i>
Operational Voltage	<i>176VAC-264VAC</i>
Load	<i>200W/gang(4/5 wire strong curtain motor)</i>



## Installation and maintenance

IP protection	<i>IP20</i>
Material	<i>PC (polycarbonate)</i>
Operating temperaturerange	<i>-10°C~40°C</i>
Installationtype	<i>wall mounted</i>

## Additional information

Quantity per box	<i>8</i>
Boxsize(mm)	<i>375*95*105</i>
Quantity per carton	<i>80</i>
Carton size(mm)	<i>495*385*220</i>



# 1 Network Environment

## 1.1 Basic Requirement for Network

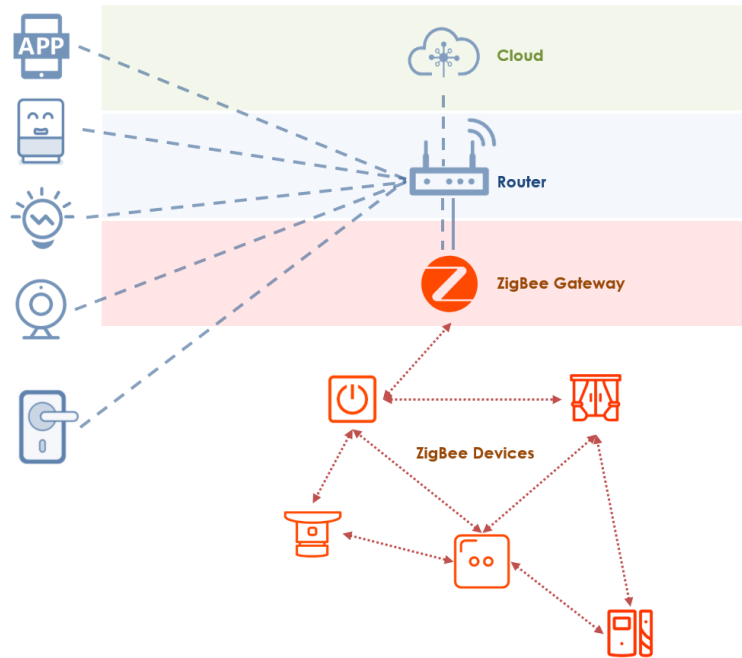

### Wi-Fi — Home Router

- Support 2.4GHz Wi-Fi, select 2.4GHz Wi-Fi signal
- 2.4G/5G combination Wi-Fi is not supported
- Can check the Wi-Fi type on the mobile phone or PC

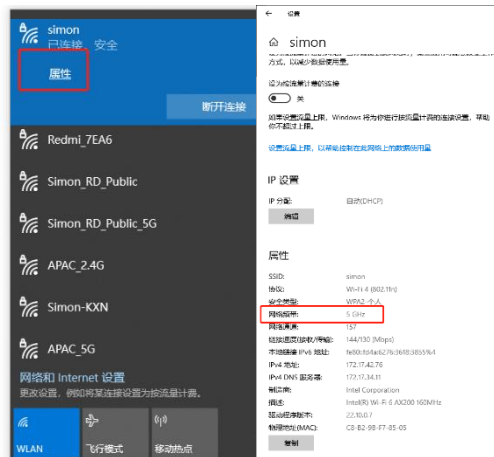

## Simon-Smart Installation Manual

---

### ZigBee — Smart Gateway

- Need to be connected with home router via network cable or Wi-Fi
- Connect ZigBee devices to internet

#### Tips: Change network environment of Smart Gateway (LAN)

- Change the Wi-Fi password/ Wi-Fi Name: Smart Gateway (LAN) and ZigBee devices under the gateway will not be influenced, but Wi-Fi devices will be offline.
- Change the router: Smart Gateway (LAN) and ZigBee devices under the gateway will not be influenced, but Wi-Fi devices will be offline.

#### Change network environment of Smart Gateway (Wireless)

- Change the Wi-Fi password/ Wi-Fi Name: Smart Gateway (LAN), ZigBee devices under the gateway and Wi-Fi devices will be offline.
- Change the router: Smart Gateway (LAN), ZigBee devices under the gateway and Wi-Fi devices will be offline.

**\*In the Situation that smart gateway and ZigBee devices under the gateway are offline, long press the button on the gateway to reset it, and make network configuration of gateway again, then they can work normally.**

**For offline Wi-Fi devices, need to reset them and make network configuration again.**

## 1.2 Smart Gateway

The smart gateway is the control center of the ZigBee device.

#### Parameters:

Code	681808TY	S00E0-S008	S00E0-S009	55E761TY/ 70E761TY/ 58E8061TY/ 72E8061TY/ 30E8061TY	S00E0-S026 S00E0-S042
Communication	LAN/ZigBee		Wi-Fi/ZigBee		Wi-Fi/ZigBee
Power Supply	USB 5V/1A			220-240V ~50/60Hz	220-240V ~50/60Hz
Recommended Number of connecting devices	Max 100	Max 100	Max 50	Max 30	Max 100

## 6 Smart Curtain Switch

### 6.1 Smart Curtain Switch (Load: High voltage curtain motor)

Code	Description
70E846TY	1 Gang Smart Curtain Switch Module
70E847TY	2 Gang Smart Curtain Switch Module
58E8013TY	1 Gang Smart Curtain Switch
58E8014TY	2 Gang Smart Curtain Switch
30E813TY	1 Gang Smart Curtain Switch
30E814TY	2 Gang Smart Curtain Switch

#### Installation Environment:

- Need to connect to L&N line in the mounting box
- Need to connect to load: 4/5wire strong current motor(choose the strong current motor can connect the smart curtain switch( Positive+ Negative control line))

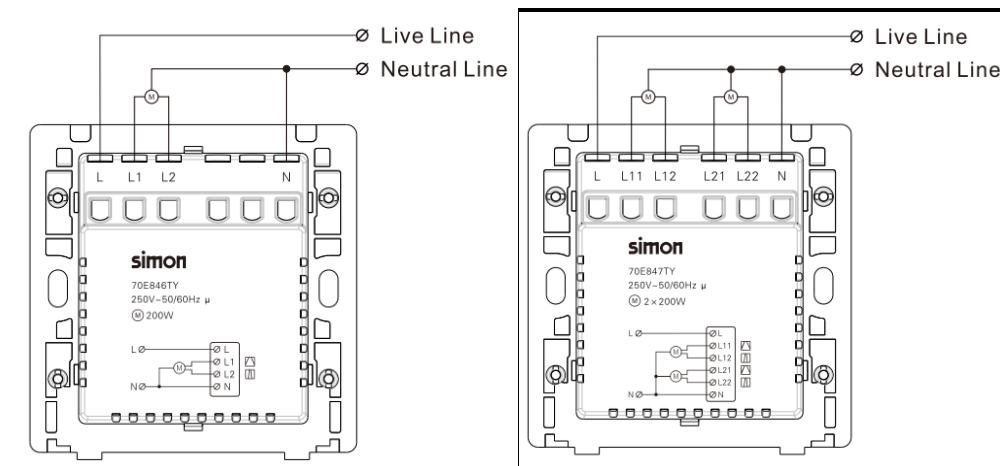

#### Preparation for Use:

- Ensure that the smart gateway has been added.
- Mobile phone is connected to Internet (Wi-Fi or 3G/4G/5G)
- Ensure effective coverage of ZigBee network. (Communication distance between any ZigBee devices: <2 walls, <100m in open area)

#### Network Configuration:

- Download and open Simon Smart APP



- Within 60s after connecting the power, insert the pin to long press the configuration hole for more than 3s until the configuration indicator flashes.

## Simon-Smart Installation Manual

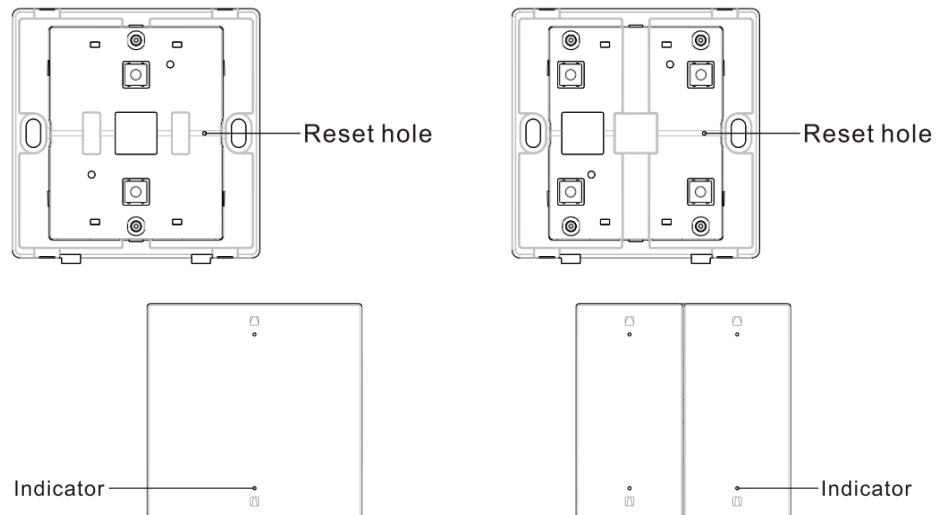

- If not flashes or you want to reset, insert the pin to long press the configuration hole for more than 5s until the configuration indicator flashes
- Enter the "Gateway" interface and click "Add Subdevice"
- Confirm that indicator is blinking, then click "LED already blink"
- Add the device as per the app prompts

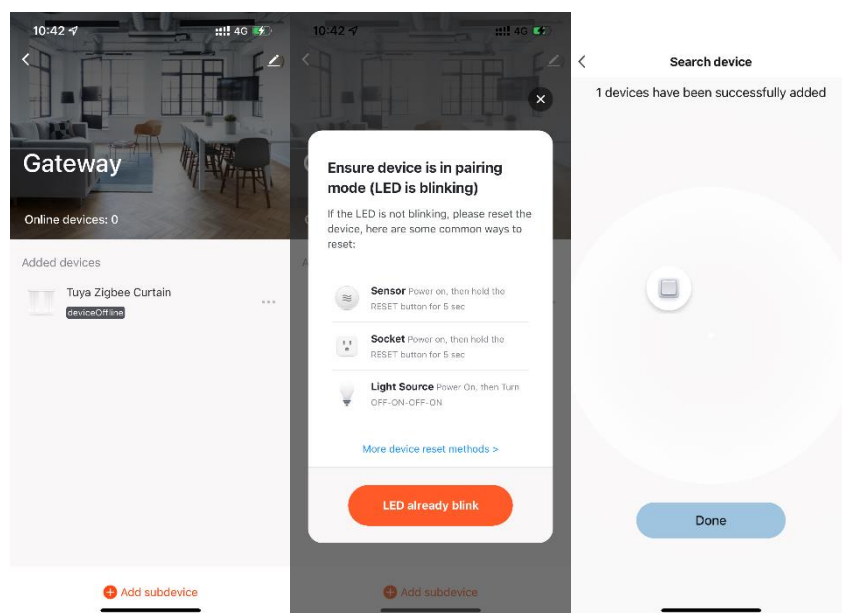

### Configuration Indicator Status:

Waiting pairing	4 quick flashes per second
Pairing success	2 flashes per second for 2s
Pairing failure	1 flash per second for 10s
Initial power on	ON for 1s
Reset success	2 flashes per second for 2s