

Simon i7

Doorbell Switch Module

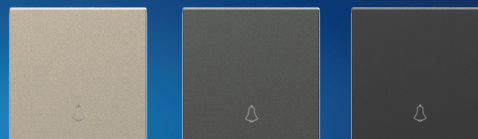

Basic Information

Model no	706301
Range	i7
Type	Push button
Finishing	white,champagne-46,grey-61,black-26

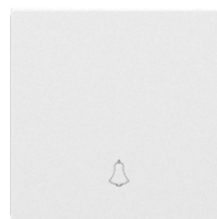

Installation and maintenance

Connection terminals type	Screw connection
IP protection	IP20
Material	PC (polycarbonate)
Operating temperature range	0 - 40°C
Installation type	Suitable for flush mounting box (76 type if multigang frame)

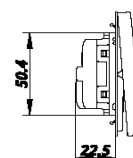
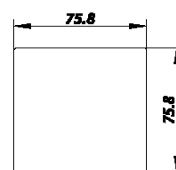

Additional information



Rated current	<i>16A</i>
Rated voltage	<i>250V</i>
Quantity per box	<i>10</i>
Box size(mm)	<i>250×180×103</i>
Quantity per carton	<i>100</i>
Carton size(mm)	<i>530×370×260</i>
Standards	<i>IEC60669</i>

